

UNAUTHORIZED USE, MANUFACTURE, OR REPRODUCTION IN WHOLE OR IN PART IS PROHIBITED.

REVISIONS

SYM	DESCRIPTION	DATE	APP'D.
-----	-------------	------	--------

SEAL FACE INCLUDING "O" RING GROOVE, ARE NICKEL PLATED AS STD. ON STEEL FLANGES.

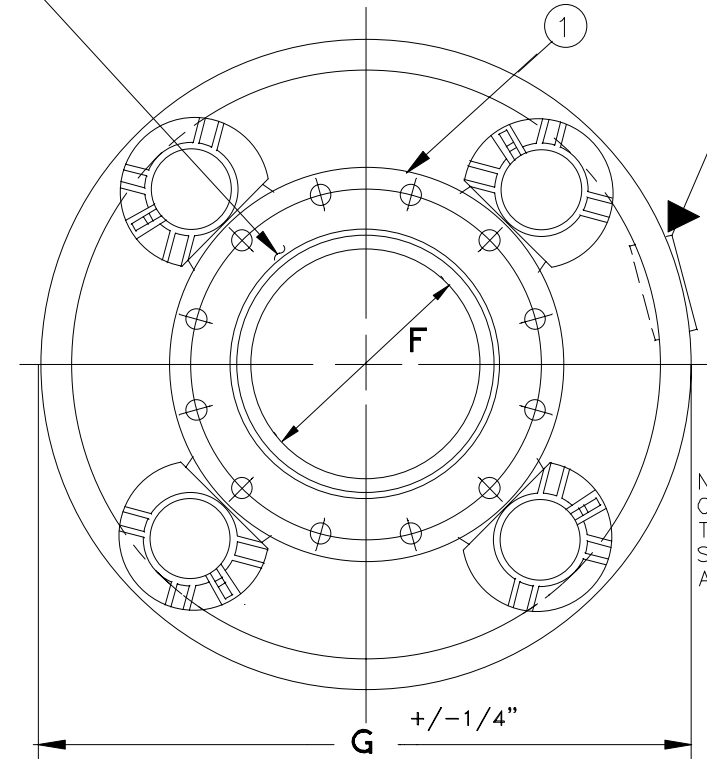

(RATCHET LOCK TYPE)

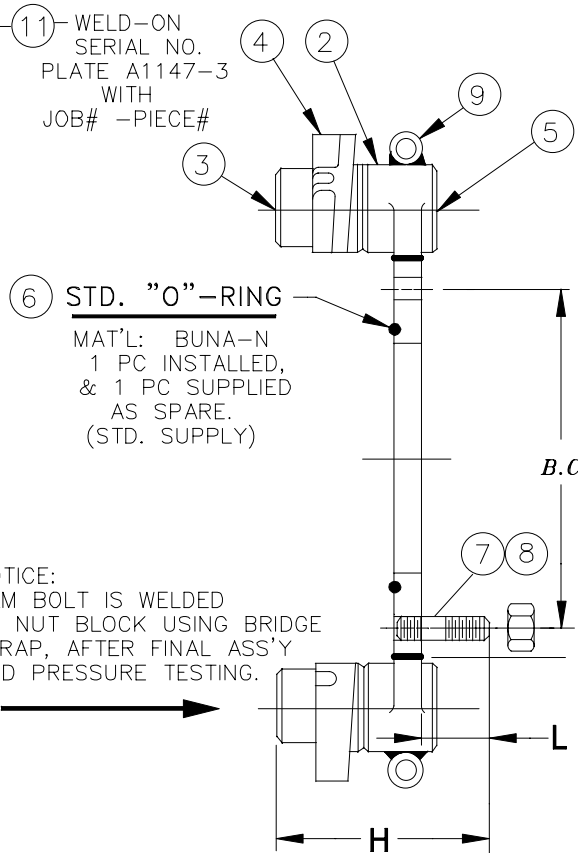

⑥ STD. "O"-RING
 MAT'L: BUNA-N
 1 PC INSTALLED,
 & 1 PC SUPPLIED
 AS SPARE.
 (STD. SUPPLY)

NOTICE:
 CAM BOLT IS WELDED
 TO NUT BLOCK USING BRIDGE
 STRAP, AFTER FINAL ASS'Y
 AND PRESSURE TESTING.

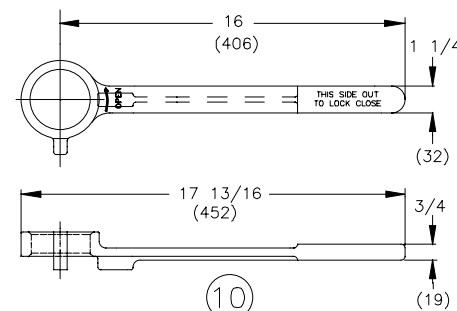

MMC BRONZE CAM LOCKING WRENCH
 (STANDARD SUUPPLY)

SIZE A.N.S.I. 150#	CAM QTY	DIM "F"	DIM "G"	DIM "H"	ASSEMBLY WEIGHT LBS KGS	BOLT CIRCLE "BC"-"L" MIN.	STUD L'GT "N"	STUD QTY
4"	3	4"	19"	6 3/8	88 40	7.5 2	8	8
6"	3	6.07"	21 3/4"	7	98 45	9.5 2 1/8	8	8
8"	3	8"	23 3/4"	7	110 50	11.75 2 1/8	8	8
10"	4	10"	27"	7 1/2	135 61	14.25 2 1/2	12	12
12"	4	12"	29 3/4"	8	146 66	17.00 2 3/4	12	12
14"	5	13.3"	32"	8 1/2	201 91	18.75 2 7/8	12	12
16"	5-6	15.3"	33 5/8"	8 3/4	210 95	21.25 2 7/8	16	16
18"	8	17.3"	35 1/4"	9 1/8	310 141	22.75 3 1/4	16	16
20"	10	19.3"	37 3/4"	9 3/8	370 168	25.00 3 3/8	20	20
24"	12	23.3"	42 3/8"	9 1/2	460 209	29.50 3 1/2	20	20

ABOVE DIM. ARE IN INCHES +/- 1/8"
 AIR WEIGHT ONLY PER ASS'Y
 "L" DIM. +/- 1/8"

1	10	WRENCH, CAM LOCKING, ALLOY 8A	BRONZE	A147
1	9	CAM GUARD RING, 1 1/4 PIPE SCH. 160 WALL THK.	STEEL	A285
SEE TABLE	8	NUT, HEX, HEAVY PATTERN	TYPE 304	STN.STL. A194
SEE TABLE	7	STUD, AMERICAN STD 60° VEE	TYPE 304	STN.STL. A193
1	6	"O"-RING, PER C-L SIZE, 1 SPARE INCLUDED	BUNA-N	
AS CAM QTY	5	GREASE FITTING, RECESSED	STN.STL.	T304
↑	4	CAM, RATCHET LOCK TYPE, INC'D RATCHET PAWL & SPRING	STN.STL.	A487
↓	3	CAM BOLT, NICKEL PLATED	STEEL	A311
AS CAM QTY	2	NUT BLOCK, CAST GRADE WCB	STEEL	A216
1	1	FLANGE, STUDDED, 150# A.N.S.I., FL'T FACE, NI-PLT., GR. 70	STEEL	A516
REQ'D	PT.#	DESCRIPTION	MAT'L	ASTM#

- NOTE:**
- EXTERIOR FINISH:
 ONE COAT EACH, PRIMER, RED OXIDE ALKYD ENAMEL.
 FINISH, JOTUN PILOT II #39W72 ENAMEL, BLUE-GRAY TINT #F-23.
 OR EQUIVALENT PRIMER/FINISH COATINGS.
 INTERIOR FINISH: ONE COAT BLACK GLOSS WATERBORNE ENAMEL.
 - STD. HYDROSTATIC TEST PRESS: 450PSI (32 KG).
 - ASSEMBLED WEIGHT IN AIR: 146# , 66KG.
 - ALL WELDING JOINT PER ASME V / API 1104.
 ALL OTHER CUSTOMER WELDING REQUIREMENTS AT EXTRA COST.
 - FLANGE DIMENSIONS, TOLERANCES, AND MATERIAL SPECIFICATION PER A.N.S.I./ASME B16.5.

MMC JOB#:	DIMENSIONAL TOLERANCES UNLESS OTHERWISE SPECIFIED	MMC 150# A.N.S.I. STUDDED C-L FLANGE SUBMERSIBLE SERVICE	MMC INTERNATIONAL CORP.
CUST:	GENERAL: +/- 1/16 (1.5)		INWOOD, L.I. NEW YORK
P.O.#:	FLG, OTHER: +/- 3/16 (5)		
DATE:	SCALE NONE NO. REQ'D	DRAWN: F.S.G DATE: 1-25-07	DWG. NO.
QT'Y:	ASS'Y PART NO. (SIZE)-H2274-2R150SDD	CHK'D: DATE:	REV
		APP'D: F.S.GIANNONE DATE:	B2274-2-STLR